



Mobile Tower Hoist

OPERATOR'S MANUAL

For Model 1027

Patent 7,484,713

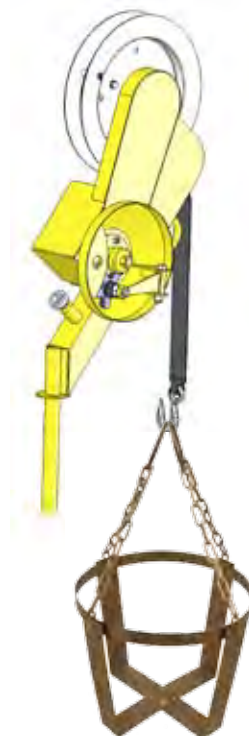

WARNING

Read and become familiar with this manual **BEFORE** operating unit.

Before operating this equipment, thoroughly read this set of instructions, make sure you understand them, and only then follow the step-by-step directions. Failure to do so could result in serious property damage and / or serious bodily injury.

To our valued customer,

Thank you for choosing a **Telpro Inc.**[®] product by **PARAGON PRO** Manufacturing Solutions. We are pleased that we are able to provide equipment to make your work easier.

Our efforts are focused on producing the finest quality equipment of which we are capable. We make sure to spend extra time and effort on our design and production in order to reduce your time and effort spent using the product.

We take pride in providing the best for our customers. Quality, innovation, and excellence are all qualities this company ensures. No product is sent without being factory tested and inspected to ensure the highest quality for you.

It all began in 1972 when Roland Young designed our first product, the PANELLIFT[®] Brand Drywall Lift, and revolutionized the drywall industry. To this day we are continuously making advancements in manufacturing and design.

Thank you again for giving us the opportunity to work with you. Any questions or comments that you have are always welcome.

PARAGON PRO
M a n u f a c t u r i n g S o l u t i o n s

Warning / Instructional Information	Pages 1
User Components & Product Specifications	Page 2
Care & Maintenance	Page 3
Installation and Operation	Page 4
Parts Index.....	Page 5
Safety Info	Page 6

ALL PHOTOS ARE FOR ILLUSTRATIVE PURPOSES ONLY.
ALWAYS WEAR PROPER PERSONAL PROTECTIVE EQUIPMENT.

Warning

Read and follow these warnings and the instructions that follow. Failure to do so could result in serious property damage and/or serious bodily injury or death.

• **BEFORE** operating this equipment, thoroughly read this set of instructions, make sure you understand them, and only then follow the step-by-step directions. **FAILURE TO READ AND FOLLOW THESE INSTRUCTIONS** could result in failure of the equipment. Failure of the equipment can include a sudden and rapid lowering of the load possibly resulting in serious property damage and/or serious bodily injury or death.

- Use and maintenance of the Tele-Tower® Mobile Tower Hoist shall be limited to authorized personnel who are trained in the proper techniques for its safe operation and maintenance and who are familiar with the various hazards of overhead material handling.
- Read and become familiar with the Tele-Tower® Adjustable Work Platform Operator's Manual **BEFORE** using the Mobile Tower Hoist. If you don't have a copy of this manual, call Telpro Inc, 701-775-0551, or e-mail telpromktg@telproinc.com for a free copy.
- As with any lifting equipment, **ALWAYS WEAR A HARD HAT** when operating the Tele-Tower® Mobile Tower Hoist and **REQUIRE WORKERS IN THE AREA TO WEAR A HARD HAT**.
- **INSPECT** the hoist carefully before each use. **DO NOT ATTEMPT TO USE YOUR TELE-TOWER® MOBILE TOWER HOIST IF ANY PART IS MISSING, DAMAGED, WORN OR NOT FUNCTIONING PROPERLY. ORDER A REPLACEMENT PART IMMEDIATELY.** Using a Tele-Tower® Mobile Tower Hoist with missing, damaged or worn components can result in failure of the unit and possibly severe property damage and/or serious bodily injury or death.
- Mount the Mobile Tower Hoist in the Hoist Rail (part #76-08) for a proper, secure connection (see page 4). **DO NOT** mount the hoist directly in the Tele-Tower® Adjustable Work Platform safety rail, since this will not provide the support required to properly and safely operate the Hoist.
- Secure the hoist to the safety rail with the safety chain (part #14-04) before using the hoist (see page 4).
- **The weight capacity of the Tele-Tower® Mobile Tower Hoist is 75 lbs. (34 kg). DO NOT load the hoist beyond this limit.**
- **DO NOT** allow tools or equipment to project above the edge of the tool bucket when lifting. Doing so can produce an off balance load that can overturn unexpectedly possibly resulting in severe property damage and/or serious bodily injury.

- **DO NOT TAMPER WITH OR ADJUST** the torque setting on the load limiting clutch of the Tele-Tower® Mobile Tower Hoist. This is factory preset for the load range of the intended use of the hoist. Altering this factory setting can subject the components of the hoist to stresses and loads that they were not designed to carry. This can result in failure of the unit which may include a sudden and rapid lowering of the load possibly resulting in serious property damage and/or serious bodily injury or death.
- **DO NOT** attempt to lower a load using the Tele-Tower® Mobile Tower Hoist without first elevating the load with the hoist to ensure that the load is within the specified weight range of the hoist. The load-limiting clutch will not hold a load greater than that for which it is preset to safely lift. A load greater than this will overload the safety clutch and the load will descend rapidly as the clutch slips, possibly resulting in serious property damage and/or serious bodily injury or death.
- Keep persons out from under loads that are being raised with the Tele-Tower® Mobile Tower Hoist. Keep children away from the work area.
- **DO NOT** leave suspended loads unattended.
- **The Tele-Tower® Mobile Tower Hoist is designed exclusively as a material lift and shall be used for no other purpose.** The Tele-Tower® Mobile Tower Hoist is not a personnel lift or platform and shall not be used as such. Using the Tele-Tower® Mobile Tower Hoist for purposes other than a material lift can subject the Hoist and the Tele-Tower® Adjustable Work Platform to forces they were not designed to carry. This can result in failure of the hoist which may include a sudden and rapid lowering of the load or failure of the Tele-Tower® Adjustable Work Platform possibly resulting in serious property damage and/or serious bodily injury or death.
- **DO NOT USE THE HOIST FOR SIDE PULLS.** Doing so can subject the structure of the Tele-Tower® Adjustable Work Platform to unsafe load forces that can result in the tipping of the structure possibly resulting in serious property damage and/or serious bodily injury or death. **LIFT ONLY.**
- Use only below-the-hook lifting devices designed and rated for this purpose.
- **DO NOT** lift buckets or pails by their handles. Use the Bucket Carrier. (part # 76-09). (See page 4.)
- Fold the crank handle before using the drill drive feature.
- Use only factory authorized replacement parts. Installation of other parts can compromise the safe design of the hoist and may cause failure of the unit possibly resulting in serious property damage and/or serious bodily injury.

Questions? - Call Paragon Pro Manufacturing Solutions Customer Service at 1-800-448-0822 or 701-775-0551

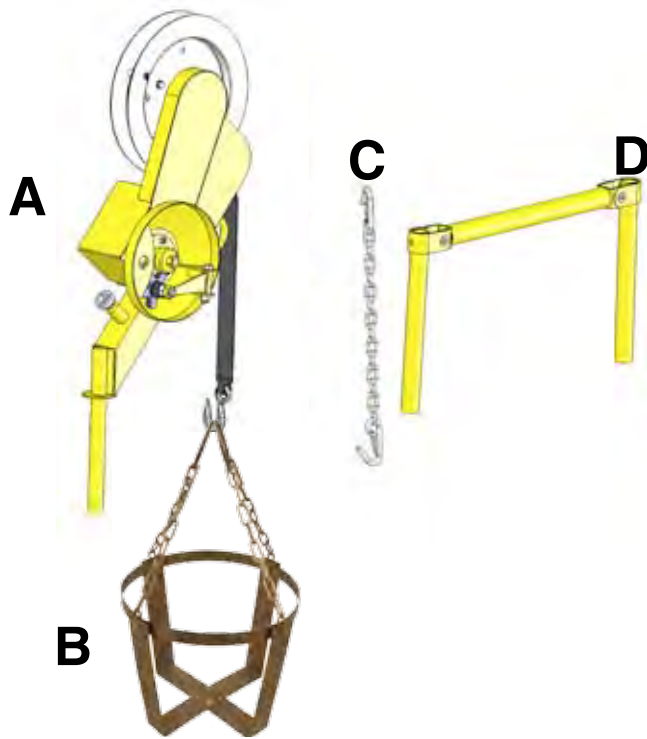

- A. Tele-Tower Mobile Tower Hoist
- B. Bucket Carrier
- C. Safety Chain
- D. Hoist Rail

LOAD RATING: 75 lbs (34 kg) DO NOT EXCEED

LIFT RANGE: 20' (6 m)

SEE PAGE 1 FOR IMPORTANT OPERATIONAL WARNINGS

CARE AND MAINTENANCE

- Inspect lift strap and hook before each use. If either is damaged, replace before using the hoist.
- Avoid damaging the edges of the strap drum.
- Store the hoist in a dry location.
- Lightly oil the drive chain occasionally.
- Maintain adequate drive chain tension by loosening the winch mount bolts, repositioning the winch and retightening the mount bolts if necessary.

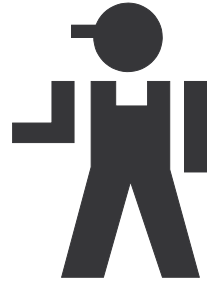

Bucket Carrier Assembly Procedure:

- #2:**
- Install the end link of each chain BETWEEN the upper ring and the vertical support straps. Fasten securely with the included bolts and nuts. (Install the nuts on the outside of the assembled carrier.)
 - Install the two ends of each chain/ring assembly on adjacent attach points as shown (not across from each other).

- #1:**
- Install the two 1/4" X 1/2" bolts diagonally from each other in either pair of holes and fasten securely with the included nuts.

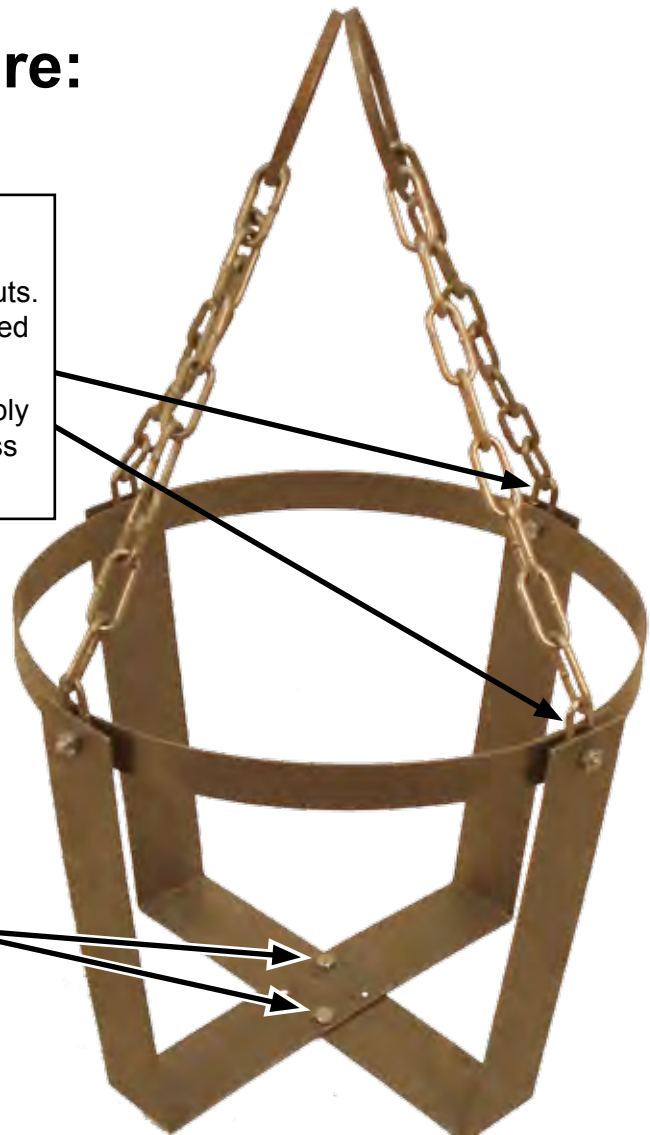

INSTALLATION & OPERATION



1. Insert the Hoist Rail into the top guard rails on the Tele-Tower®.



2. Insert the Hoist into the Hoist Rail.
WARNING: Always use the Hoist Rail. **Never** insert the hoist directly into the guard rail, since this will not provide the support required to properly and safely operate the Hoist.

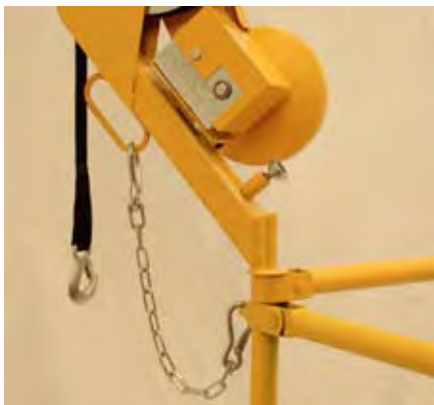

3. Connect the Hoist to the guard rail with the safety chain.

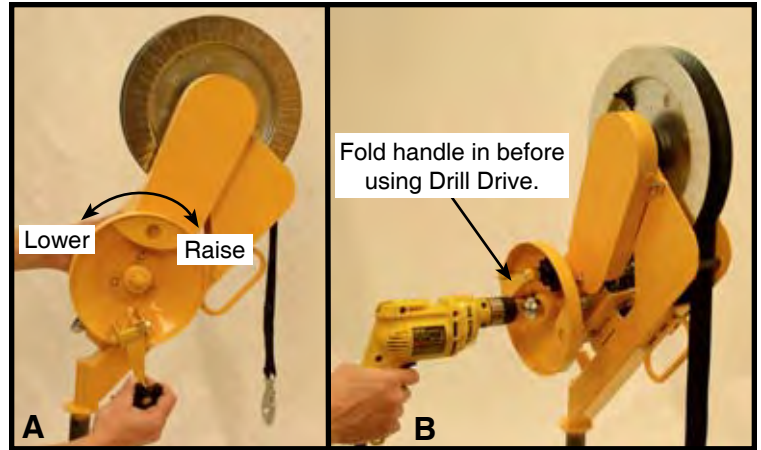

- 4a. Raise and lower the hoist as needed with the flip out handle.
- 4b. If you use the DrillDrive adapter, be sure to fold the handle in first.



5. You can lower the empty hoist quickly by folding the handle and using the spinner hole.



6. When lifting buckets, **ALWAYS** use the Bucket Sling and connect both rings to the hook. **NEVER** lift buckets by their handles with the Hoist.

PARTS INDEX Model 1027

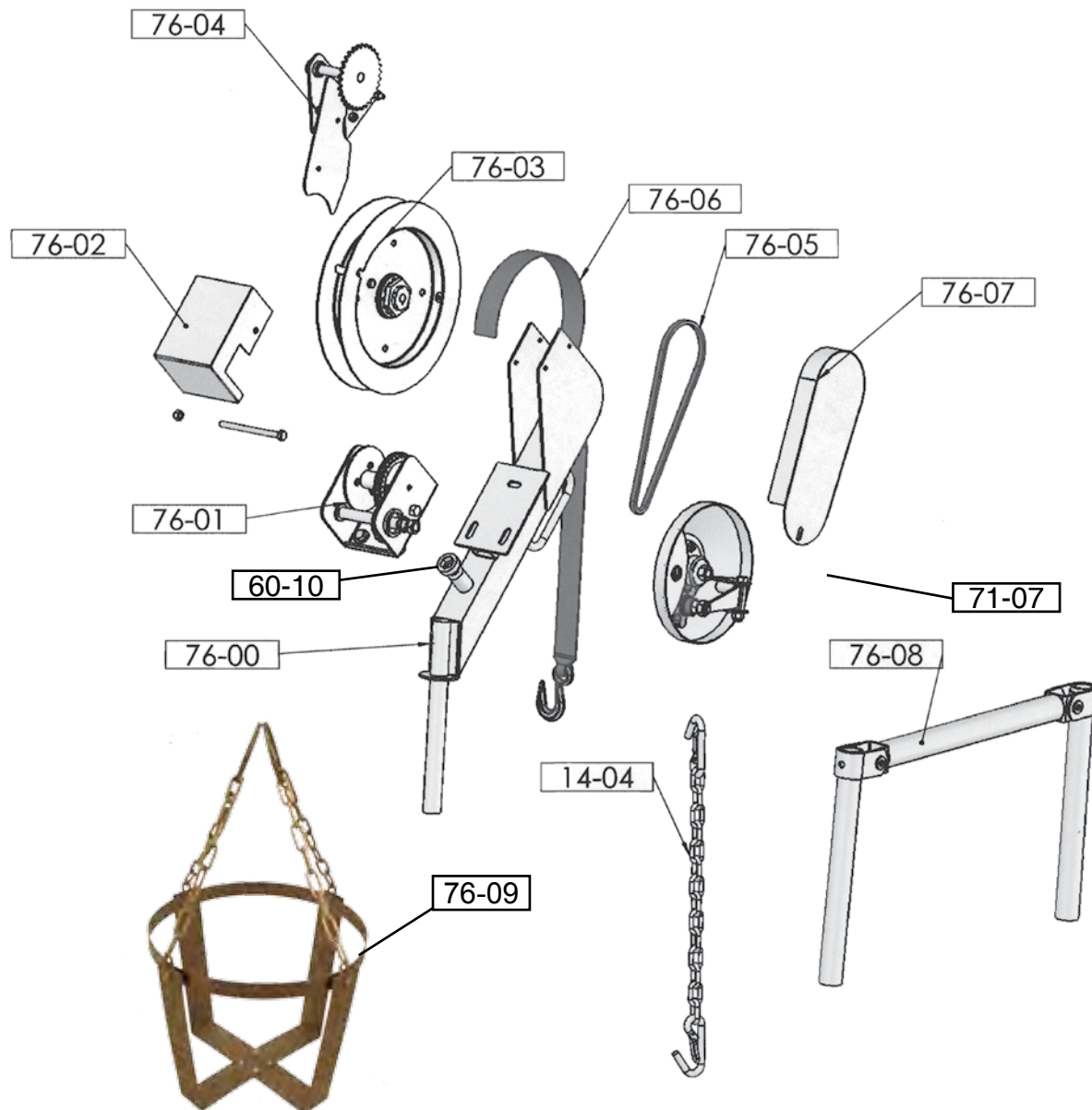

Part #	Description
60-10	3/4" Driver Adapter
71-70	Drill Drive Winch Drum Assembly
76-00	Frame w/ Fasteners
76-01	Bucket Lift Winch w/ Fasteners
76-02	Bucket Lift Guard w/ Fasteners
76-03	Drum w/ Torque Limiter
76-04	Keyed Shaft w/ Side Guards
76-05	#35-40 Pin Chain
76-06	Bucket Lift Strap w/ Hook
76-07	Guard w/ Fasteners
76-08	Hoist Rail
76-09	Bucket Sling Assembly
14-04	Large Hook Chain

This product contains trace amounts of the following items which are known to cause cancer and/or developmental harm in the state of California.

These chemicals are not hazardous under product's intended use.

Please review CAS# for more information.

Chemical	Hazard	CAS#	% By Weight
Arsenic	Cancer	7440-38-2	Trace
Cadmium	Developmental	7440-43-9	Trace
Chromium	Cancer, Developmental	7440-47-3	Trace
Ethylbenzene	Cancer	100-41-4	Trace
Lead	Cancer	7439-92-1	Trace
Methanol	Developmental	67-56-1	Trace
Methylene Chloride (Dichloromethane)	Cancer	75-09-2	Trace
Nickel	Cancer	7440-02-0	Trace
Propylene glycol monobutyl ether	Cancer	5131-66-8	Trace
Toluene	Developmental	108-88-3	Trace

